

P.C.B. LAYOUT

MATERIALS:

1. Housing: PBT (UL 94V-0), Blue / Black
2. Contacts: Brass
3. Shell: SPCC
4. Rivet: Copper Alloy(Lead \leq 40000PPM)
5. Board Lock: SPCC
6. Screw: SPCC
Or Copper Alloy(Lead \leq 40000PPM)

FINISH:

1. Contacts: Gold Flash Plated on Contact Area
Tin Plated on Soldertails
Nickel Under Plated Over All
2. Shell: Nickel Plated
3. Rivet: Nickel Plated
4. Board Lock: Tin Plated
5. Screw: Nickel Plated

SPECIFICATION:

1. Current Rating: 2 Amp
2. Dielectric Withstanding Voltage: AC 500V For 1 minute
3. Insulation Resistance: 5000M Ω Min
4. Contact Resistance: 30m Ω Max.
5. Operating Temperature: -55°C to +105°C

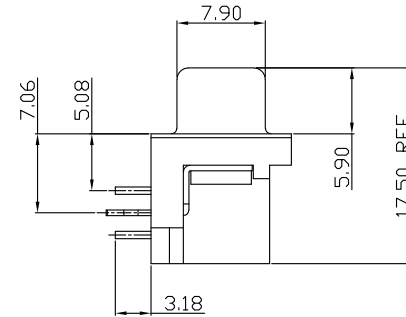
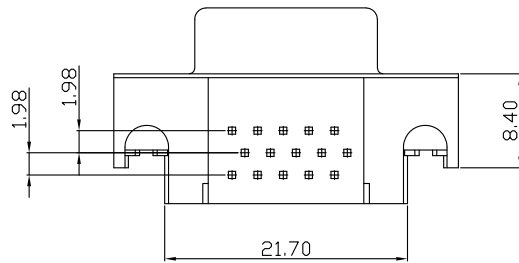

鉚合型

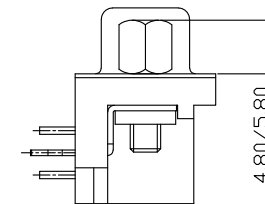

鉚合鎖螺絲型

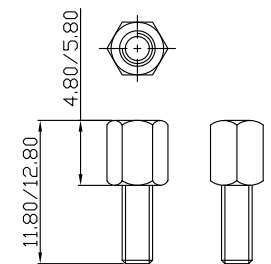

僅供參考

XIAN YI PRECISION CO., LTD.

祥益精密股份有限公司

TITLE / 品名: VGA 90度 15母 (板邊距5.08) Dip Type

PART NO / 料號: D2210-15F-RXXXX

核準發行章

APPROVE / 核準

CHECKED / 審查

DRAWING / 繪圖

DRAWING NO / 圖號

UNIT / 單位

SHEET 1 OF 1

NO.

REV / 版本

圖面僅供參考, 實際尺寸以承認圖為主

2025/12/19

日期

Kin

Chenrong

Chenrong

K-0D-014-00

mm

SHEET 1 OF 1

1.0

修訂內容

日期