

- MATERIALS:**
- Housing: PBT (UL 94V-0), Black
 - Contacts: Brass
 - Shell: SPCC
 - Rivet: Copper Alloy(Lead ≤ 40000PPM)
 - Board Lock: SPCC
 - Screw: SPCC
- Or Copper Alloy(Lead ≤ 40000PPM)

- FINISH:**
- Contacts: Gold Flash Plated on Contact Area
Tin Plated on Solderetails
Nickel Under Plated Over All
 - Shell: Nickel Plated
 - Rivet: Nickel Plated
 - Board Lock: Tin Plated
 - Screw: Nickel Plated

- SPECIFICATION:**
- Current Rating: 2 Amp
 - Dielectric Withstanding Voltage: AC 500V r.m.s.
 - Insulation Resistance: 5000MΩ Min. at DC 500V
 - Contact Resistance: 30mΩ Max.
 - Operating Temperature: -55°C to 105°C

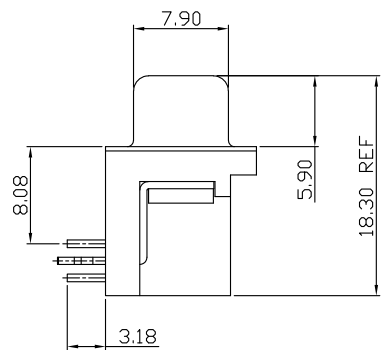
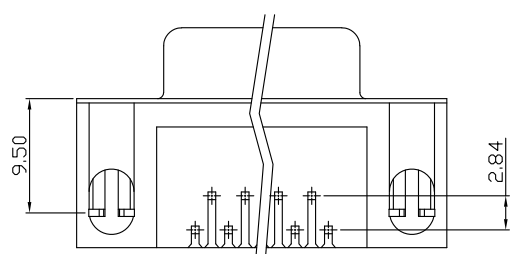

鉗合型

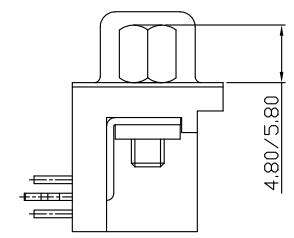

鉗合鎖螺絲型

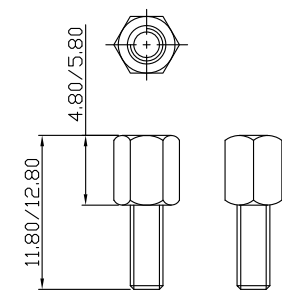

僅供參考

NO. OF POS.	A	B	C
09Pin	30.80	24.99	16.33
15Pin	39.20	33.32	24.66
25Pin	53.04	47.04	38.38
37Pin	69.40	63.50	54.80

XIAN YI PRECISION CO., LTD.
祥益精密股份有限公司

TITLE / 品名: D-Sub 90度 二排 母座 (板邊距8.08) Dip Type

PART NO / 料號: D1110-xxF-Rxxxx

核準發行章

APPROVE / 核準	CHECKED / 審查	DRAWING / 繪圖	DRAWING NO / 圖號	UNIT / 單位	⊕	△
<i>Kin</i>	<i>Chenrong</i>	<i>Chenrong</i>	K-0D-003-00	mm		

SHEET 1 OF 1	X
NO. REV / 版本	

1.0	圖面僅供參考, 實際尺寸以承認圖為主	2025/12/19
	修訂內容	日期