

- MATERIALS:**
- Housing: PBT (UL 94V-0), Black / Blue
 - Contacts: Brass
 - Shell: SPCC
 - Rivet: Copper Alloy (Lead \leq 40000PPM)
 - Board Lock: SPCC
 - Screw: SPCC
Or Copper Alloy (Lead \leq 40000PPM)

- FINISH:**
- Contacts: Gold Flash Plated on Contact Area
Tin Plated on Solderails
Nickel Under Plated Over All
 - Shell: Nickel Plated
 - Rivet: Nickel Plated
 - Board Lock: Tin Plated
 - Screw: Nickel Plated

- SPECIFICATION:**
- Current Rating: 2 Amp
 - Dielectric Withstanding Voltage: AC 500V For 1 minute
 - Insulation Resistance: 5000M Ω Min
 - Contact Resistance: 30m Ω Max.
 - Operating Temperature: -55°C to +105°C

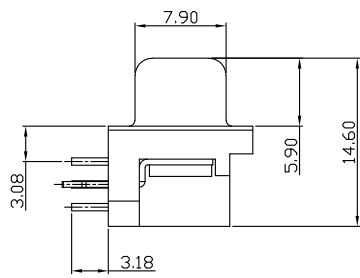
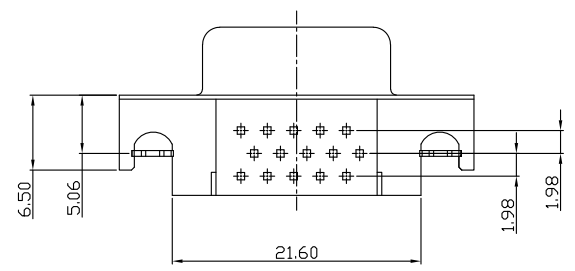

鉗合型

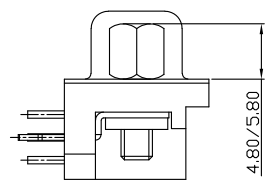

鉗合鎖螺絲型

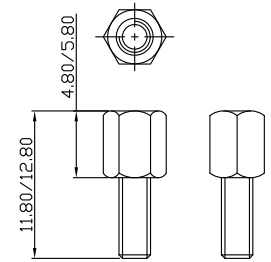

僅供參考

XIAN YI PRECISION CO., LTD.
祥益精密股份有限公司

TITLE / 品名: VGA 90度 15母 (板邊距3.08) Dip Type

PART NO / 料號: D2310-15F-Rxxxx

核準發行章

APPROVE / 核準	CHECKED / 審查	DRAWING / 繪圖	DRAWING NO / 圖號	UNIT / 單位	
<i>Kin</i>	<i>Chenrong</i>	<i>Chenrong</i>	K-0D-007-00	mm	

SHEET 1 OF 1	

NO.	REV / 版本	圖面僅供參考, 實際尺寸以承認圖為主	2025/12/19
		修訂內容	日期